

## Spherically Seated Compression Plates



The advantage of this type of compression plate set, which is comprised of a spherically seated upper compression plate and a fixed lower compression plate, is the ability of the upper spherically seated plate to self-align when contacting the specimen surface. This enables the application of a uniform load to non-parallel specimens such as finished products.

Spherically seated compression plate sets are available with diameters of 100 mm (3.9 in), 210 mm (8.3 in), and 310 mm (12.2 in). The surface hardness of both the upper and lower compression plate is 60 on the Rockwell HRC scale.

The upper plate attaches to a compression and bending loading jig and the bottom plate fits onto the table of the universal tester.

Spherically seated compression plates, which include a compression and bending loading jig in addition to the upper and lower plate set, are also available as kits in some regions. Please contact your local Shimadzu representative for details.

### Relevant Materials

Plastics, Metals, Rubber, Lumber, Cement

### Relevant Specimens

Cylinders, Cubes, Cuboids

### Operation

For best results, the specimen should be centered along the loading axis of the testing machine.



Connect the joint and plate, and fix by screw

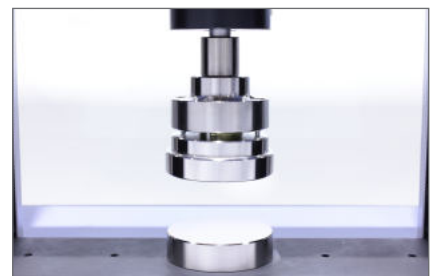

Upper and lower compression plates should be mounted parallel

## Specification

Maximum Capacity			Plate Diameter	Applicable Specimen Diameter	Temperature Range	Upper Plate Mass
kN	kgf	lbf	mm (in)	mm (in)	°C (°F)	kg (lb)
250	25,000	55,000	310 (12.2)	0 to 310 (0 to 12.2)	0 to 40 (32 to 104)	66.0 (146)
250	25,000	55,000	210 (8.3)	0 to 210 (0 to 8.3)	0 to 40 (32 to 104)	42.5 (93.7)
250	25,000	55,000	100 (3.9)	0 to 100 (0 to 3.9)	0 to 40 (32 to 104)	3.8 (8.4)

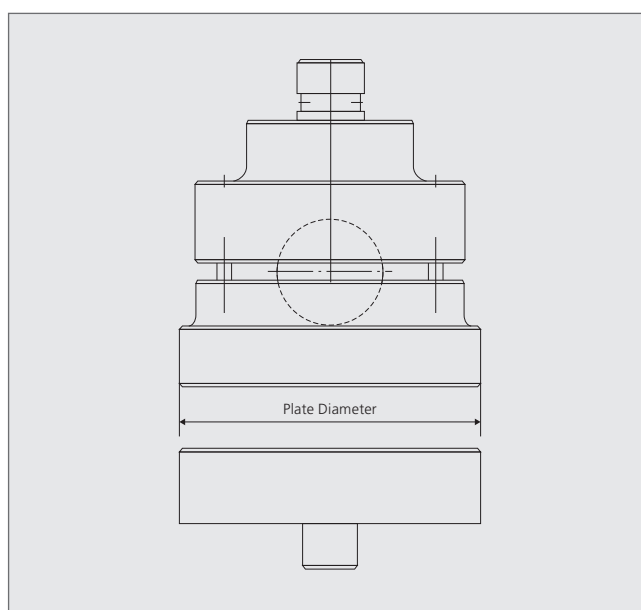

## Ordering Information

P/N	Description
<b>Spherically Seated Compression Plate Sets</b> Includes: upper spherically seated compression plate and lower fixed compression plate	
346-50639-32	310 mm diameter spherically seated compression plate set
346-50639-31	210 mm diameter spherically seated compression plate set
346-50639-03	100 mm diameter spherically seated compression plate set

Second Edition: May, 2015



Company names, product/service names and logos used in this publication are trademarks and trade names of Shimadzu Corporation or its affiliates, whether or not they are used with trademark symbol "TM" or "®". Third-party trademarks and trade names may be used in this publication to refer to either the entities or their products/services. Shimadzu disclaims any proprietary interest in trademarks and trade names other than its own.

For Research Use Only. Not for use in diagnostic procedures. The contents of this publication are provided to you "as is" without warranty of any kind, and are subject to change without notice. Shimadzu does not assume any responsibility or liability for any damage, whether direct or indirect, relating to the use of this publication.